

MMKP82 series / Double-sided Metallized polypropylene film capacitor (Box-type)

### General Technical Characteristics 一般特性

Double sided metallized polypropylene film  
 金属化聚丙烯膜  
 Low loss and small inherent temperature rise  
 损耗小, 内部温升小  
 Negative temperature coefficient of capacitance  
 负点容量温度系数  
 Excellent active and passive flame resistant circuit  
 优异的阻燃系数  
 Plastic case (UL94 V-0), epoxy resin sealing, excellent flame retardant and moisture proof  
 塑胶外壳 (UL94 V-0), 阻燃环氧填充

### Applications 应用

Widely used in high voltage, high frequency and pulse circuit.  
 广泛应用于高压高频脉冲电路中  
 Lamp capacitor for electronic ballast compact lamps  
 用于电子电子镇流器和节能灯中  
 Snubber and SCR commutating circuits  
 吸收和SCR整流电路

### Electrical Characteristics 电气特性

Reference standard 引用标准: GB/T 10190 (IEC60384-16)  
 Climatic Category 气候类别: 40/105/56  
 Rated Temperature 额定温度: 85°C for V<sub>R</sub>(DC); 75°C for V<sub>R</sub>(AC)  
 Operating Temperature Range: -40°C ~ 105°C  
 工作温度范围: (+85°C to +105°C: decreasing factor 1.25% per °C for U<sub>RDC</sub>)  
 (+75°C to +105°C: decreasing factor 1.35% per °C for U<sub>RAc</sub>)  
 Rated Voltage 额定电压: 250VDC/180VAC, 400VDC/250VAC, 630VDC/400VAC, 1000VDC/600VAC, 1600VDC/650VAC, 2000VDC/700VAC  
 Capacitance Range 电容量范围: 0.00022μF ~ 3.9μF  
 Capacitance Tolerance 电容量偏差: ±5% (J), ±10%(K)  
 Dissipation factor 损耗角正切: ≤10×10<sup>-4</sup> Measured at 1KHz and 20°C.  
 Test Voltage 耐电压: 1.6U<sub>R</sub> for 5 sec and 20°C.  
 Insulation resistance 绝缘电阻: ≥50000MΩ C<sub>R</sub>≤ 0.33 μF; ≥15000S, C<sub>R</sub>>0.33 μF. Measured at 20°C, 100V and 1 min.

### Outline Drawing 外形图

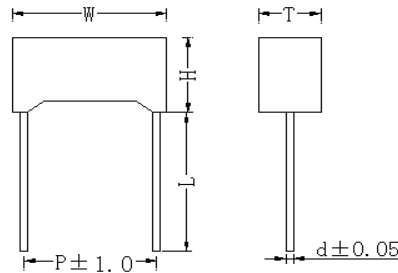

### Part Number System 产品编码说明

K6R	2J	333	J	F	L	0	20	***
型号代码	额定电压	标称容量	容量偏差	引线脚距 P	引线加工/包装代码	引线加工脚距	引线长度	内部编码
Series Code:	Voltage:	Capacitance:	Cap. Tol.:	Lead Space:	Lead form and packaging code:	Lead form F:	Lead length:	Internal code
K6R:	2E=250VDC	101=0.0001μF	J=± 5%	E=7.5mm	L=straight lead	0=none	05=5mm	code
MMKP82	2G=400VDC	102=0.001μF	K=± 10%	F=10.0mm	L=lead kinked	D=5.0mm	20=20mm	
Series	2J=630VDC	103=0.01μF		H=15.0mm	T=ammo-pack	E=7.5mm		
	3A=1000VDC	104=0.1μF		J=22.5mm		F=10.0mm		
	3B=1250VDC			L=27.5mm		H=15.0mm		
	3C=1600VDC							
	3D=2000VDC							

MMKP82 series / Double-sided Metallized polypropylene film capacitor (Box-type)

■ Electrical Specification & Part Numbers Reference 规格型号参考

Unit: mm (±0.5mm)

Cap. (μF)	250VDC(180VAC)					Part Number
	W	H	T	P	d	
0.0068	10.0	9.0	4.0	7.5	0.6	K6R2E682*****
0.0082	10.0	9.0	4.0	7.5	0.6	K6R2E822*****
0.010	10.0	9.0	4.0	7.5	0.6	K6R2E103*****
0.012	10.0	9.0	4.0	7.5	0.6	K6R2E123*****
0.015	10.0	9.0	4.0	7.5	0.6	K6R2E153*****
0.018	10.0	9.0	4.0	7.5	0.6	K6R2E183*****
0.022	10.0	9.0	4.0	7.5	0.6	K6R2E223*****
0.027	10.0	11.0	5.0	7.5	0.6	K6R2E273*****
0.033	10.0	11.0	5.0	7.5	0.6	K6R2E333*****
0.039	10.0	12.0	6.0	7.5	0.6	K6R2E393*****
0.047	10.0	12.0	6.0	7.5	0.6	K6R2E473*****
0.027	13.0	9.0	4.0	10.0	0.6	K6R2E273*****
0.033	13.0	9.0	4.0	10.0	0.6	K6R2E333*****
0.039	13.0	9.0	4.0	10.0	0.6	K6R2E393*****
0.047	12.0	11.0	5.0	10.0	0.6	K6R2E473*****
0.056	12.0	11.0	5.0	10.0	0.6	K6R2E563*****
0.068	13.0	12.0	6.0	10.0	0.6	K6R2E683*****
0.082	13.0	12.0	6.0	10.0	0.6	K6R2E823*****
0.068	18.0	11.0	5.0	15.0	0.6	K6R2E683*****
0.082	18.0	11.0	5.0	15.0	0.6	K6R2E823*****
0.10	18.0	11.0	5.0	15.0	0.6	K6R2E104*****
0.12	18.0	12.0	6.0	15.0	0.6	K6R2E124*****
0.15	18.0	12.0	6.0	15.0	0.6	K6R2E154*****
0.18	18.0	13.5	7.5	15.0	0.8	K6R2E184*****
0.22	18.0	13.5	7.5	15.0	0.8	K6R2E224*****
0.27	18.0	14.5	8.5	15.0	0.8	K6R2E274*****
0.33	18.0	16.0	10.0	15.0	0.8	K6R2E334*****
0.39	18.0	16.0	10.0	15.0	0.8	K6R2E394*****
0.22	26.5	15.0	6.0	22.5	0.8	K6R2E224*****
0.27	26.5	15.0	6.0	22.5	0.8	K6R2E274*****
0.33	26.5	15.0	6.0	22.5	0.8	K6R2E334*****
0.39	26.5	16.0	7.0	22.5	0.8	K6R2E394*****
0.47	26.5	16.0	7.0	22.5	0.8	K6R2E474*****
0.56	26.5	17.0	8.5	22.5	0.8	K6R2E564*****
0.68	26.5	19.0	10.0	22.5	0.8	K6R2E684*****
0.82	26.5	19.0	10.0	22.5	0.8	K6R2E824*****
1.0	26.5	22.0	12.0	22.5	0.8	K6R2E105*****
0.82	32.0	18.0	9.0	27.5	0.8	K6R2E824*****
1.0	32.0	20.0	11.0	27.5	0.8	K6R2E105*****
1.2	32.0	20.0	11.0	27.5	0.8	K6R2E125*****
1.5	32.0	22.0	13.0	27.5	0.8	K6R2E155*****
1.8	32.0	24.5	15.0	27.5	0.8	K6R2E185*****
2.2	32.0	24.5	15.0	27.5	0.8	K6R2E225*****
2.7	32.0	33.0	18.0	27.5	0.8	K6R2E275*****
3.3	32.0	33.0	18.0	27.5	0.8	K6R2E335*****
3.9	32.0	33.0	18.0	27.5	0.8	K6R2E395*****

Cap. (μF)	400VDC(250VAC)					Part Number
	W	H	T	P	d	
0.0027	10.0	9.0	4.0	7.5	0.6	K6R2G272*****
0.0033	10.0	9.0	4.0	7.5	0.6	K6R2G332*****
0.0039	10.0	9.0	4.0	7.5	0.6	K6R2G392*****
0.0047	10.0	9.0	4.0	7.5	0.6	K6R2G472*****
0.0056	10.0	9.0	4.0	7.5	0.6	K6R2G562*****
0.0068	10.0	9.0	4.0	7.5	0.6	K6R2G682*****
0.0082	10.0	9.0	4.0	7.5	0.6	K6R2G822*****
0.010	10.0	9.0	4.0	7.5	0.6	K6R2G103*****
0.012	10.0	9.0	4.0	7.5	0.6	K6R2G123*****
0.015	10.0	11.0	5.0	7.5	0.6	K6R2G153*****
0.018	10.0	11.0	5.0	7.5	0.6	K6R2G183*****
0.022	10.0	12.0	6.0	7.5	0.6	K6R2G223*****
0.027	10.0	12.0	6.0	7.5	0.6	K6R2G273*****
0.010	13.0	9.0	4.0	10.0	0.6	K6R2G103*****
0.012	13.0	9.0	4.0	10.0	0.6	K6R2G123*****
0.015	13.0	9.0	4.0	10.0	0.6	K6R2G153*****
0.018	13.0	9.0	4.0	10.0	0.6	K6R2G183*****
0.022	13.0	9.0	4.0	10.0	0.6	K6R2G223*****
0.027	12.0	11.0	5.0	10.0	0.6	K6R2G273*****
0.033	12.0	11.0	5.0	10.0	0.6	K6R2G333*****
0.039	13.0	12.0	6.0	10.0	0.6	K6R2G393*****
0.047	13.0	12.0	6.0	10.0	0.6	K6R2G473*****
0.033	18.0	11.0	5.0	15.0	0.6	K6R2G333*****
0.039	18.0	11.0	5.0	15.0	0.6	K6R2G393*****
0.047	18.0	11.0	5.0	15.0	0.6	K6R2G473*****
0.056	18.0	11.0	5.0	15.0	0.6	K6R2G563*****
0.068	18.0	12.0	6.0	15.0	0.6	K6R2G683*****
0.082	18.0	12.0	6.0	15.0	0.6	K6R2G823*****
0.10	18.0	13.5	7.5	15.0	0.8	K6R2G104*****
0.12	18.0	13.5	7.5	15.0	0.8	K6R2G124*****
0.15	18.0	14.5	8.5	15.0	0.8	K6R2G154*****
0.18	18.0	16.0	10.0	15.0	0.8	K6R2G184*****
0.22	18.0	16.0	10.0	15.0	0.8	K6R2G224*****
0.27	18.0	19.0	11.0	15.0	0.8	K6R2G274*****
0.12	26.5	15.0	6.0	22.5	0.8	K6R2G124*****
0.15	26.5	15.0	6.0	22.5	0.8	K6R2G154*****
0.18	26.5	16.0	7.0	22.5	0.8	K6R2G184*****
0.22	26.5	16.0	7.0	22.5	0.8	K6R2G224*****
0.27	26.5	17.0	8.5	22.5	0.8	K6R2G274*****
0.33	26.5	17.0	8.5	22.5	0.8	K6R2G334*****
0.39	26.5	19.0	10.0	22.5	0.8	K6R2G394*****
0.47	26.5	19.0	10.0	22.5	0.8	K6R2G474*****
0.56	26.5	22.0	12.0	22.5	0.8	K6R2G564*****
0.68	26.5	22.0	12.0	22.5	0.8	K6R2G684*****
0.82	26.5	22.0	12.0	22.5	0.8	K6R2G824*****
1.0	32.0	24.5	15.0	27.5	0.8	K6R2G105*****
1.2	32.0	24.5	15.0	27.5	0.8	K6R2G125*****
1.5	32.0	33.0	18.0	27.5	0.8	K6R2G155*****
1.8	32.0	33.0	18.0	27.5	0.8	K6R2G185*****

备注: 1. "\*\*\*\*\*" = Capacitance tolerance code, Pitch, Lead form and packaging code, Lead form, Lead length, Internal code.

"\*\*\*\*\*" 表示容量偏差, 引线脚距, 引线加工和包装代码, 引线加工脚距, 引线长度, 内部编码。

2. Customization for special specification and requirement is available.

MMKP82 series / Double-sided Metallized polypropylene film capacitor (Box-type)

■ Electrical Specification & Part Numbers Reference 规格型号参考

Unit: mm (±0.5mm)

Cap. (μF)	630VDC(400VAC)					Part Number
	W	H	T	P	d	
0.00068	10.0	9.0	4.0	7.5	0.6	K6R2J681*****
0.00082	10.0	9.0	4.0	7.5	0.6	K6R2J821*****
0.0010	10.0	9.0	4.0	7.5	0.6	K6R2J102*****
0.0012	10.0	9.0	4.0	7.5	0.6	K6R2J122*****
0.0015	10.0	9.0	4.0	7.5	0.6	K6R2J152*****
0.0018	10.0	9.0	4.0	7.5	0.6	K6R2J182*****
0.0022	10.0	9.0	4.0	7.5	0.6	K6R2J222*****
0.0027	10.0	9.0	4.0	7.5	0.6	K6R2J272*****
0.0033	10.0	9.0	4.0	7.5	0.6	K6R2J332*****
0.0039	10.0	9.0	4.0	7.5	0.6	K6R2J392*****
0.0047	10.0	9.0	4.0	7.5	0.6	K6R2J472*****
0.0056	10.0	9.0	4.0	7.5	0.6	K6R2J562*****
0.0068	10.0	11.0	5.0	7.5	0.6	K6R2J682*****
0.0082	10.0	11.0	5.0	7.5	0.6	K6R2J822*****
0.010	10.0	12.0	6.0	7.5	0.6	K6R2J103*****
0.012	10.0	12.0	6.0	7.5	0.6	K6R2J123*****
0.0039	13.0	9.0	4.0	10.0	0.6	K6R2J392*****
0.0047	13.0	9.0	4.0	10.0	0.6	K6R2J472*****
0.0056	13.0	9.0	4.0	10.0	0.6	K6R2J562*****
0.0068	13.0	9.0	4.0	10.0	0.6	K6R2J682*****
0.0082	13.0	9.0	4.0	10.0	0.6	K6R2J822*****
0.010	12.0	11.0	5.0	10.0	0.6	K6R2J103*****
0.012	12.0	11.0	5.0	10.0	0.6	K6R2J123*****
0.015	13.0	12.0	6.0	10.0	0.6	K6R2J153*****
0.018	13.0	12.0	6.0	10.0	0.6	K6R2J183*****
0.010	18.0	11.0	5.0	15.0	0.6	K6R2J103*****
0.012	18.0	11.0	5.0	15.0	0.6	K6R2J123*****
0.015	18.0	11.0	5.0	15.0	0.6	K6R2J153*****
0.018	18.0	11.0	5.0	15.0	0.6	K6R2J183*****
0.022	18.0	11.0	5.0	15.0	0.6	K6R2J223*****
0.027	18.0	11.0	5.0	15.0	0.6	K6R2J273*****
0.033	18.0	12.0	6.0	15.0	0.8	K6R2J333*****
0.039	18.0	12.0	6.0	15.0	0.8	K6R2J393*****
0.047	18.0	12.0	6.0	15.0	0.8	K6R2J473*****
0.056	18.0	13.5	7.5	15.0	0.8	K6R2J563*****
0.068	18.0	14.5	8.5	15.0	0.8	K6R2J683*****
0.082	18.0	16.0	10.0	15.0	0.8	K6R2J823*****
0.10	18.0	16.0	10.0	15.0	0.8	K6R2J104*****
0.12	18.0	19.0	11.0	15.0	0.8	K6R2J124*****
0.047	26.5	15.0	6.0	22.5	0.8	K6R2J473*****
0.056	26.5	15.0	6.0	22.5	0.8	K6R2J563*****
0.068	26.5	15.0	6.0	22.5	0.8	K6R2J683*****
0.082	26.5	15.0	6.0	22.5	0.8	K6R2J823*****
0.1	26.5	15.0	6.0	22.5	0.8	K6R2J104*****
0.12	26.5	16.0	7.0	22.5	0.8	K6R2J124*****
0.15	26.5	17.0	8.5	22.5	0.8	K6R2J154*****
0.18	26.5	17.0	8.5	22.5	0.8	K6R2J184*****
0.22	26.5	19.0	10.0	22.5	0.8	K6R2J224*****
0.27	26.5	22.0	12.0	22.5	0.8	K6R2J274*****
0.33	26.5	22.0	12.0	22.5	0.8	K6R2J334*****
0.39	26.5	22.0	12.0	22.5	0.8	K6R2J394*****
0.15	32.0	18.0	9.0	27.5	0.8	K6R2J154*****
0.18	32.0	18.0	9.0	27.5	0.8	K6R2J184*****
0.22	32.0	18.0	9.0	27.5	0.8	K6R2J224*****

Cap. (μF)	630VDC(400VAC)					Part Number
	W	H	T	P	d	
0.27	32.0	18.0	9.0	27.5	0.8	K6R2J274*****
0.33	32.0	20.0	11.0	27.5	0.8	K6R2J334*****
0.39	32.0	20.0	11.0	27.5	0.8	K6R2J394*****
0.47	32.0	22.0	13.0	27.5	0.8	K6R2J474*****
0.56	32.0	22.0	13.0	27.5	0.8	K6R2J564*****
0.68	32.0	24.5	15.0	27.5	0.8	K6R2J684*****
0.82	32.0	28.0	14.0	27.5	0.8	K6R2J824*****
1.0	32.0	33.0	18.0	27.5	0.8	K6R2J105*****
1.2	32.0	33.0	18.0	27.5	0.8	K6R2J125*****

备注: 1. "\*\*\*\*\*" = Capacitance tolerance code, Pitch, Lead form and packaging code, Lead form, Lead length, Internal code.

"\*\*\*\*\*" 表示容量偏差, 引线脚距, 引线加工和包装代码, 引线加工脚距, 引线长度, 内部编码。

2. Customization for special specification and requirement is available.

MMKP82 series / Double-sided Metallized polypropylene film capacitor (Box-type)

■ Electrical Specification & Part Numbers Reference 规格型号参考

Unit: mm (±0.5mm)

Cap. (µF)	1000VDC(600VAC)					Part Number
	W	H	T	P	d	
0.00047	10.0	9.0	4.0	7.5	0.6	K6R3A471*****
0.00056	10.0	9.0	4.0	7.5	0.6	K6R3A561*****
0.00068	10.0	9.0	4.0	7.5	0.6	K6R3A681*****
0.00082	10.0	9.0	4.0	7.5	0.6	K6R3A821*****
0.001	10.0	9.0	4.0	7.5	0.6	K6R3A102*****
0.0012	10.0	9.0	4.0	7.5	0.6	K6R3A122*****
0.0015	10.0	9.0	4.0	7.5	0.6	K6R3A152*****
0.0018	10.0	9.0	4.0	7.5	0.6	K6R3A182*****
0.0022	10.0	9.0	4.0	7.5	0.6	K6R3A222*****
0.0027	10.0	11.0	5.0	7.5	0.6	K6R3A272*****
0.0033	10.0	11.0	5.0	7.5	0.6	K6R3A332*****
0.001	10.0	12.0	6.0	7.5	0.6	K6R3A102*****
0.0012	10.0	12.0	6.0	7.5	0.6	K6R3A122*****
0.0015	13.0	9.0	4.0	10.0	0.6	K6R3A152*****
0.0018	13.0	9.0	4.0	10.0	0.6	K6R3A182*****
0.0022	13.0	9.0	4.0	10.0	0.6	K6R3A222*****
0.0027	13.0	9.0	4.0	10.0	0.6	K6R3A272*****
0.0033	13.0	9.0	4.0	10.0	0.6	K6R3A332*****
0.0039	12.0	11.0	5.0	10.0	0.6	K6R3A392*****
0.0047	12.0	11.0	5.0	10.0	0.6	K6R3A472*****
0.0056	13.0	12.0	6.0	10.0	0.6	K6R3A562*****
0.0068	13.0	12.0	6.0	10.0	0.6	K6R3A682*****
0.0082	18.0	11.0	5.0	15.0	0.6	K6R3A822*****
0.010	18.0	11.0	5.0	15.0	0.6	K6R3A103*****
0.012	18.0	11.0	5.0	15.0	0.6	K6R3A123*****
0.015	18.0	11.0	5.0	15.0	0.6	K6R3A153*****
0.018	18.0	12.0	6.0	15.0	0.8	K6R3A183*****
0.022	18.0	13.5	7.5	15.0	0.8	K6R3A223*****
0.027	18.0	14.5	8.5	15.0	0.8	K6R3A273*****
0.033	18.0	16.0	10.0	15.0	0.8	K6R3A333*****
0.039	18.0	16.0	10.0	15.0	0.8	K6R3A393*****
0.047	18.0	19.0	11.0	15.0	0.8	K6R3A473*****
0.027	26.5	15.0	6.0	22.5	0.8	K6R3A273*****
0.033	26.5	15.0	6.0	22.5	0.8	K6R3A333*****
0.039	26.5	16.0	7.0	22.5	0.8	K6R3A393*****
0.047	26.5	16.0	7.0	22.5	0.8	K6R3A473*****
0.056	26.5	17.0	8.5	22.5	0.8	K6R3A563*****
0.068	26.5	17.0	8.5	22.5	0.8	K6R3A683*****
0.082	26.5	19.0	10.0	22.5	0.8	K6R3A823*****
0.10	26.5	19.0	10.0	22.5	0.8	K6R3A104*****
0.12	26.5	22.0	12.0	22.5	0.8	K6R3A124*****
0.15	26.5	22.0	12.0	22.5	0.8	K6R3A154*****
0.10	32.0	18.0	9.0	27.5	0.8	K6R3A104*****
0.12	32.0	18.0	9.0	27.5	0.8	K6R3A124*****
0.15	32.0	20.0	11.0	27.5	0.8	K6R3A154*****
0.18	32.0	20.0	11.0	27.5	0.8	K6R3A184*****
0.22	32.0	22.0	13.0	27.5	0.8	K6R3A224*****
0.27	32.0	24.5	15.0	27.5	0.8	K6R3A274*****
0.33	32.0	24.5	15.0	27.5	0.8	K6R3A334*****
0.39	32.0	33.0	18.0	27.5	0.8	K6R3A394*****
0.47	32.0	33.0	18.0	27.5	0.8	K6R3A474*****

Cap. (µF)	1600VDC (650VAC)					Part Number
	W	H	T	P	d	
0.00068	18.0	11.0	5.0	15.0	0.8	K6R3C681*****
0.00082	18.0	11.0	5.0	15.0	0.8	K6R3C821*****
0.0010	18.0	11.0	5.0	15.0	0.8	K6R3C102*****
0.0012	18.0	11.0	5.0	15.0	0.8	K6R3C122*****
0.0015	18.0	11.0	5.0	15.0	0.8	K6R3C152*****
0.0018	18.0	11.0	5.0	15.0	0.8	K6R3C182*****
0.0022	18.0	11.0	5.0	15.0	0.8	K6R3C222*****
0.0027	18.0	11.0	5.0	15.0	0.8	K6R3C272*****
0.0033	18.0	11.0	5.0	15.0	0.8	K6R3C332*****
0.0039	18.0	11.0	5.0	15.0	0.8	K6R3C392*****
0.0047	18.0	11.0	5.0	15.0	0.8	K6R3C472*****
0.0056	18.0	11.0	5.0	15.0	0.8	K6R3C562*****
0.0068	18.0	11.0	5.0	15.0	0.8	K6R3C682*****
0.0082	18.0	12.0	6.0	15.0	0.8	K6R3C822*****
0.010	18.0	12.0	6.0	15.0	0.8	K6R3C103*****
0.012	18.0	13.5	7.5	15.0	0.8	K6R3C123*****
0.015	18.0	13.5	7.5	15.0	0.8	K6R3C153*****
0.018	18.0	14.5	8.5	15.0	0.8	K6R3C183*****
0.022	18.0	14.5	8.5	15.0	0.8	K6R3C222*****
0.027	18.0	16.0	10.0	15.0	0.8	K6R3C272*****
0.033	18.0	19.0	11.0	15.0	0.8	K6R3C332*****
0.015	26.5	15.0	6.0	22.5	0.8	K6R3C153*****
0.018	26.5	15.0	6.0	22.5	0.8	K6R3C183*****
0.022	26.5	15.0	6.0	22.5	0.8	K6R3C223*****
0.027	26.5	15.0	6.0	22.5	0.8	K6R3C273*****
0.033	26.5	16.0	7.0	22.5	0.8	K6R3C333*****
0.039	26.5	17.0	8.5	22.5	0.8	K6R3C393*****
0.047	26.5	19.0	10.0	22.5	0.8	K6R3C473*****
0.056	26.5	19.0	10.0	22.5	0.8	K6R3C563*****
0.068	26.5	22.0	12.0	22.5	0.8	K6R3C683*****
0.082	26.5	22.0	12.0	22.5	0.8	K6R3C823*****
0.039	32.0	18.0	9.0	27.5	0.8	K6R3C393*****
0.047	32.0	18.0	9.0	27.5	0.8	K6R3C473*****
0.056	32.0	18.0	9.0	27.5	0.8	K6R3C563*****
0.068	32.0	18.0	9.0	27.5	0.8	K6R3C683*****
0.082	32.0	20.0	11.0	27.5	0.8	K6R3C823*****
0.10	32.0	20.0	11.0	27.5	0.8	K6R3C104*****
0.12	26.5	22.0	12.0	22.5	0.8	K6R3C124*****
0.15	32.0	24.5	15.0	27.5	0.8	K6R3C154*****
0.18	32.0	24.5	15.0	27.5	0.8	K6R3C184*****
0.22	32.0	24.5	15.0	27.5	0.8	K6R3C224*****
0.27	32.0	24.5	15.0	27.5	0.8	K6R3C274*****
0.33	32.0	33.0	18.0	27.5	0.8	K6R3C334*****

备注: 1. "\*\*\*\*\*" = Capacitance tolerance code, Pitch, Lead form and packaging code, Lead form, Lead length, Internal code.

"\*\*\*\*\*" 表示容量偏差, 引线脚距, 引线加工和包装代码, 引线加工脚距, 引线长度, 内部编码。

2. Customization for special specification and requirement is available.

MMKP82 series / Double-sided Metallized polypropylene film capacitor (Box-type)

■ Electrical Specification & Part Numbers Reference 规格型号参考

Unit: mm (±0.5mm)

Cap. (μF)	2000VDC (700VAC)					Part Number
	W	H	T	P	d	
0.00022	18.0	11.0	5.0	15.0	0.8	K6R3D221*****
0.00027	18.0	11.0	5.0	15.0	0.8	K6R3D271*****
0.00033	18.0	11.0	5.0	15.0	0.8	K6R3D331*****
0.00039	18.0	11.0	5.0	15.0	0.8	K6R3D391*****
0.00047	18.0	11.0	5.0	15.0	0.8	K6R3D471*****
0.00056	18.0	11.0	5.0	15.0	0.8	K6R3D561*****
0.00068	18.0	11.0	5.0	15.0	0.8	K6R3D681*****
0.00082	18.0	11.0	5.0	15.0	0.8	K6R3D821*****
0.0010	18.0	11.0	5.0	15.0	0.8	K6R3D102*****
0.0012	18.0	11.0	5.0	15.0	0.8	K6R3D122*****
0.0015	18.0	11.0	5.0	15.0	0.8	K6R3D152*****
0.0018	18.0	11.0	5.0	15.0	0.8	K6R3D182*****
0.0022	18.0	11.0	5.0	15.0	0.8	K6R3D222*****
0.0027	18.0	11.0	5.0	15.0	0.8	K6R3D272*****
0.0033	18.0	12.0	6.0	15.0	0.8	K6R3D332*****
0.0039	18.0	12.0	6.0	15.0	0.8	K6R3D392*****
0.0047	18.0	12.0	6.0	15.0	0.8	K6R3D472*****
0.0056	18.0	13.5	7.5	15.0	0.8	K6R3D562*****
0.0068	18.0	13.5	7.5	15.0	0.8	K6R3D682*****
0.0082	18.0	14.5	8.5	15.0	0.8	K6R3D822*****
0.010	18.0	16.0	10.0	15.0	0.8	K6R3D103*****
0.012	18.0	16.0	10.0	15.0	0.8	K6R3D123*****
0.015	18.0	19.0	11.0	15.0	0.8	K6R3D153*****
0.0010	26.5	15.0	6.0	22.5	0.8	K6R3D102*****
0.0012	26.5	15.0	6.0	22.5	0.8	K6R3D122*****
0.0015	26.5	15.0	6.0	22.5	0.8	K6R3D152*****
0.0018	26.5	15.0	6.0	22.5	0.8	K6R3D182*****
0.0022	26.5	15.0	6.0	22.5	0.8	K6R3D222*****
0.0027	26.5	15.0	6.0	22.5	0.8	K6R3D272*****
0.0033	26.5	15.0	6.0	22.5	0.8	K6R3D332*****
0.0039	26.5	15.0	6.0	22.5	0.8	K6R3D392*****
0.0047	26.5	15.0	6.0	22.5	0.8	K6R3D472*****
0.0056	26.5	15.0	6.0	22.5	0.8	K6R3D562*****
0.0068	26.5	15.0	6.0	22.5	0.8	K6R3D682*****
0.0082	26.5	15.0	6.0	22.5	0.8	K6R3D822*****
0.010	26.5	15.0	6.0	22.5	0.8	K6R3D103*****
0.012	26.5	15.0	6.0	22.5	0.8	K6R3D123*****
0.015	26.5	16.0	7.0	22.5	0.8	K6R3D153*****
0.018	26.5	16.0	7.0	22.5	0.8	K6R3D183*****
0.022	26.5	17.0	8.5	22.5	0.8	K6R3D223*****
0.027	26.5	19.0	10.0	22.5	0.8	K6R3D273*****
0.033	26.5	19.0	10.0	22.5	0.8	K6R3D333*****
0.039	26.5	22.0	12.0	22.5	0.8	K6R3D393*****
0.047	26.5	22.0	12.0	22.5	0.8	K6R3D473*****

Cap. (μF)	2000VDC (700VAC)					Part Number
	W	H	T	P	d	
0.022	32.0	18.0	9.0	27.5	0.8	K6R3D223*****
0.027	32.0	18.0	9.0	27.5	0.8	K6R3D273*****
0.033	32.0	18.0	9.0	27.5	0.8	K6R3D333*****
0.039	32.0	20.0	11.0	27.5	0.8	K6R3D393*****
0.047	32.0	20.0	11.0	27.5	0.8	K6R3D473*****
0.056	32.0	22.0	13.0	27.5	0.8	K6R3D563*****
0.068	32.0	22.0	13.0	27.5	0.8	K6R3D683*****
0.082	32.0	24.5	15.0	27.5	0.8	K6R3D823*****
0.10	32.0	28.0	14.0	27.5	0.8	K6R3D104*****
0.12	32.0	33.0	18.0	27.5	0.8	K6R3D124*****
0.15	32.0	33.0	18.0	27.5	0.8	K6R3D154*****

备注: 1. "\*\*\*\*\*" = Capacitance tolerance code, Pitch, Lead form and packaging code, Lead form, Lead length, Internal code.

"\*\*\*\*\*" 表示容量偏差, 引线脚距, 引线加工和包装代码, 引线加工脚距, 引线长度, 内部编码。

2. Customization for special specification and requirement is available.